

NOTES1:

- 1. Rated voltage/current : 300V / 16A
- 2. Withstanding voltage : AC1600V/1Min.
- 3. Wire range : 12~28AWG
- 4. Ratings : Use group B,C 300V AC/DC
Use group D 600V AC/DC

IEC Standard

1. Pollution degree	2	2	3
Overvoltage category	II	III	III
Rate impulse voltage(KV)	6KV	6KV	6KV
Rate voltage(V)	1000V	630V	500V
Rate current(A)	20A		

2. Wire range : 0.2~2.5mm²

NOTES2:

- 1. Dimension shall be interpreted per ASME Y14.5-2009
- 2. Pitch : 7.50mm, Poles : N=02~12P
- 3. Stripping length : 8mm
- 4. Operating temperature: -40°C~+105°C
- 5. Undimensioned tolerances:

Pitch range in mm	Nominal dimension range in mm			D
	Over	TO	Over	
6	10	TO	30	Over
10	TO	TO	60	100
24	TO	TO	100	150
±0.15	±0.20	±0.30	±0.50	±0.70
			±1.00	±1.30
				±2°

6. RoHS Compliance

Ordering Information

JL9EDGK - 750 XX B 0 1

Pitch
750=7.50PH

No. of pins
2P~15P

Housing Color
B=Black
G=Green
U=Blue
R=Red
V=White
Y=Yellow
D=Orange
E=Grey

Packing
0=Pe bag
A=Tray
T=Tube

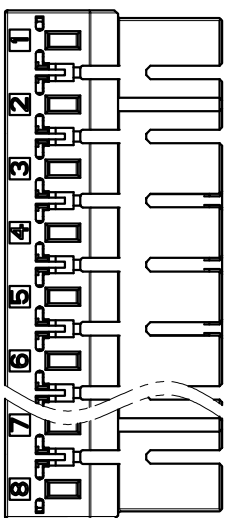
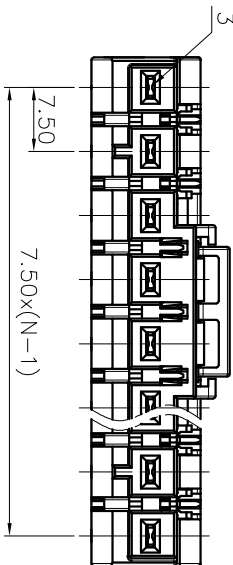
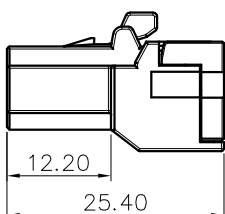
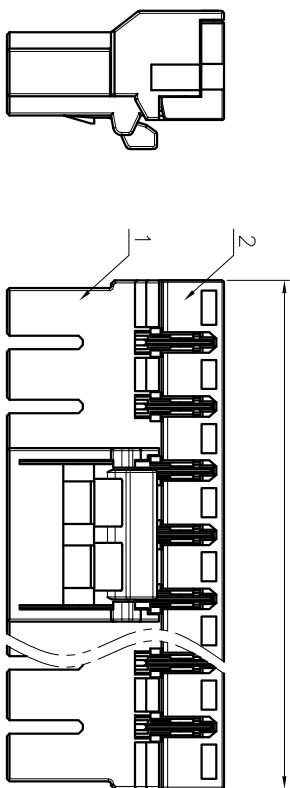
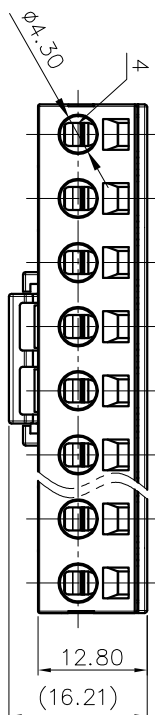

ITEM	NAME OF PART	MATERIAL	NOTES
4	Spring	Stainless Steel	
3	Clamp	Copper alloy	Sr/Au Plated
2	Cover	PA66+GF	UL94V-0
1	Housing	PA66+GF	UL94V-0

JIN 东莞市锦凌电子有限公司
DONGGUAN JINLING ELECTRONIC CO., LTD

PART NO. JL9EDGK-750XXB01

TITLE: JL9EDGK-7.5母端/接线端子台

REVISION RECORD

REV	ECN	DESCRIPTION	DRFT	DATE

DRAW	LICHAO LIU	SCALE	FIT
CHECK	LICHAO LIU	UNIT	mm
APPROVE	G. Y. L	SIZE	A4
		SHEET	1/1
		PROJ.	